



SUPPLEMENTARY REGULATIONS

PERMIT NUMBER: KV0202/2018

1. STANDARD REQUIREMENTS

1. MEETING TITLE:	Victorian Country series		
2. DATE:	Start: Saturday, 17 February 2018 End: Sunday, 18 February 2018		
3. ORGANISATION:	The Meeting will be held under the International Sporting Code of the FIA, and the National Competition Rules of Karting Australia and the Victorian State Regulations.		
4. MEETING STATUS:	State Series		
5. ORGANISER: (This will normally be the Club or a Promoter)			
5.1.	South West Kart Club		
5.2.	PO Box 119 Cobden 3266		
5.3.	Tel: 0467275723	Email:	Whites03@bigpond.com
6. ORGANISING COMMITTEE: Include the names of at least 2 people who make up the Organising Committee. Note: they must not be Stewards of the Meeting.	Russell White Michael Clover		
OFFICIALS OF THE MEETING:			
7. ESSENTIAL OFFICIALS (Ref: General Rules Chapter 7 Rule 4 – "Essential Officials")			
Stewards of the Meeting:	Trevor Crane (Chief Steward) Bob Vagg Liza Fahey Kevin O'Donahue		
Clerk of the Course:	Adam Bourke		
Chief Scrutineer:	Ron Shiells		
Emergency and Medical Services:	Sam Saffin		
8. OTHER OFFICIALS			
Assistant Clerks Of The Course:	David Hayes Alan Handley		
Grid Marshal	Chris Place		
Scales Marshal	Michael Clover		
Starter	Kevin Hitchcock		
Scrutineers	Dennis Hogan		
Chief Timekeeper	Russell White		
Secretary of the Meeting	Russell White		
State Official's Co-ordinator	Glenn Wall		
Additional Judges of Fact, Start	Clerk of Course and Ass Clerks of Course		



9. CIRCUIT DETAILS	
Circuit Name:	Cobden Park Raceway
Circuit Address:	Graylands Rd Cobden
Track Length:	966 Metres
Direction Of Racing:	Anti Clockwise
Track Density:	36
Notice Board:	In shed behind out-grid
Stewards Office:	South end toilet block
Mechanical Breakdown Lane:	Will Not be in use at this Meeting.
Parc Fermé:	In-grid & behind scale shed

2. ADMINISTRATION

1.	The Classes, Age and Weight Divisions listed below are permitted to Compete at this Meeting. Class names as used in the 2018 Australian Karting Manual or approved Sportsman Class Names must be used.		
COMPULSORY COMPETITION CLASSES	DIVISION/ WEIGHT	DISCRETIONARY COMPETITION CLASSES	DIVISION/ WEIGHT
Cadet 9	Single Division	TaG Restricted	Senior Light
Cadet 12	Single Division	TaG Restricted	Senior Medium
KA4	Junior Light	TaG Restricted	Senior Heavy
KA3	Junior	Victorian Masters @172kg Evo 177kg.	Masters
KA3	Senior Light	KA4	Junior Heavy
KA3	Senior Medium		
TaG 125	Light		
TaG 125	Heavy		
Note: Consolidation of Class Rules (Competition Rules - Chapter 1, Rule 9) may be applied.			
2.	ENTRIES		
2.1.	Entries Open:	12.00am 15/01/2018	
2.2.	Entries Close:	9.00pm 14/02/2018	
2.3.	Late Entries:	In accordance with State Regulations "Late Entries" Will be accepted. Note: A surcharge for a Late Entry Will apply.	
2.4.	Late Entries Close:	2.30pm 17/02/2018	



3.	ENTRY FEE			
3.1.	The Entry Fee for each Class at this Meeting including GST and TDF Levy is as follows:			
	Competition Class Name	Entry Fee		
	All Classes	\$80		
	Cadet and Junior Classes	\$80		
	Senior Classes	\$80		
	Second or Third Class & family members	\$65		
	Late Entry Surcharge	\$15		
4.	ENTRY PROCEDURE			
4.1.	Each Entry for this Meeting may be made using the CMS as follows:			
	<ul style="list-style-type: none"> Log on to your driver information via http://www.karting.net.au/ Click on the licence and entries icon (top centre of the screen) Click on the "Enter a Race Meeting" icon Enter your log on details Under 'My Details' functions, choose 'Pre Enter Race Meeting' Choose the State in which the Meeting is being held Choose the Club who is the Organiser of the Meeting Drivers using a free entry are to contact Race Secretary whites03@bigpond.com with race details. 			
4.2.	Payment of the Entry Fee can be made as follows:			
	Credit Card:	<table border="1"> <tr> <td>Visa</td> <td>Mastercard</td> </tr> </table>	Visa	Mastercard
Visa	Mastercard			
	Payment at the Track Will be accepted for late entries only			
	If accepted, the following payment methods are available:			
	Cash			
5.	MINIMUM ENTRIES			
5.1.	6 is the minimum number of pre entries which must be received for each Class and/or Division.			
5.2.	<p>If insufficient entries are received for a Class and/or Division to form in its own right, the Compulsory Competition Classes will be Consolidated in accordance with Competition Rules - Chapter 1, Rule 9.</p> <p>Discretionary Competition Classes may be Consolidated in accordance with the Rules or cancelled at the discretion of the Organiser and in accordance with the Rules.</p>			
5.3.	If a Class or Division is cancelled, the Entry Fee may be refunded at the discretion of the Organiser and in accordance with the Rules.			



3. COMPETITION

1.	FORMAT OF RACING					
2.	Practice	From 9.00am Saturday 17/02/18 will be held.				
3.	Qualifying	There will be Timed Qualifying at this Event.				
		There will be one (1) Qualifying session which will be combined with a warm up session of 6 Mins The order of Karts on the grid for the commencement of Qualifying must be random – no high/low numbers)				
4.	Heats & Final	The system of gridding will be in accordance with State Regulations - Series Competition				
5.	DISTANCES					
	Heat 1	9 laps	Heat 2	9 laps	Final	13 laps
6.	ACCESS TO CIRCUIT					
6.1.	Competitors will be permitted to enter the Circuit from 10am on 16/02/2018					
7.	DRIVERS BRIEFING					
7.1	DATE:	18/02/2018	TIME:	7.40am	LOCATION:	Out-grid
8.	FUEL					
8.1.	PULP is the only fuel permitted to be used at this Meeting.					
8.2.	Control Fuel Will be used at this Meeting.					
8.3.	Supply details for Control Fuel (if used) are:					
8.4.	BP Ultimate 98 fuel for use at this Meeting must be purchased from:					
8.5.	BP Camperdown Roadhouse 319 Manifold st Camperdown (cnr Manifold & Bowen st)					
8.6.	Proof of purchase of the Control Fuel must be retained and produced to the Chief Scrutineer or Fuel Tester if required.					
9.	TIMETABLE					
9.1	Saturday 17/02/2018					
	Time	Activity				
a)	6.00am	Gates open				
b)	7.00am	Breakfast				
c)	9.00am to 5.00pm	Practice				
d)	10.00am	Canteen opens				
e)	2.30pm	Close of entries				
f)	2.30pm	Scrutineering				
g)	6.30pm	Dinner in Clubrooms				
9.2	Sunday 18/02/18					
a)	6.00am	Gates open				
b)	6.30am	Breakfast				
c)	7.40am	Drivers Briefing				



d)	8.00am	Qualifying/Racing
e)	At end of racing + ½ hr	Presentations
10.	TROPHIES & PRIZES	
10.1.	a)	Trophies for 1 st 2 nd & 3 rd in each class

4. CIRCUIT SPECIFIC REQUIREMENTS

1.	Paddock Allocation
	Paddock allocation Will Not occur for the Meeting except for pre-paid sites, see notes attached
2.	MEDICAL SERVICES
2.1.	Any Medical assistance that is required outside of the operating hours when Kart's are not on the Race Track please contact 000. The address to give to the Emergency Services is:
	"Your Specific Location"
	Cobden Park raceway
	Graylands Rd Cobden
3.	KART RETRIEVAL
3.1.	Pit Crew with trolleys will not be given access to the Circuit during Qualifying and Racing.
3.2.	Retrieval of Karts is at the discretion of the Clerk of the Course & Ass Clerks of Course
3.3.	Pit Crew must only enter the Circuit when permitted by the Grid Marshal and then only if wearing a HIGH VISIBILITY SAFETY VEST on the upper torso.
3.4.	Karts can be retrieved via Out-grid
4.	ADDITIONAL VENUE REQUIREMENTS
4.1.	Subject to any applicable laws which may govern the access of animals, including but not limited to guide dogs, no animals are allowed anywhere within the facility.
4.2.	No dumping of Fuel or Tyres, please make own arrangements.
4.3.	No unlicensed driving of motor vehicles permitted at the Circuit.
4.4.	No motorised scooters, mini bikes, roller blading, skateboards and tricycles allowed at the complex during the entire Meeting. Officials may confiscate any such items for the duration of the Meeting.
5.	Marquees are not to be erected without consent of the Club.

The Southwest Kart club is again offering 24 reserved pit sites to Karters at our upcoming Country series meeting. These sites will be in close proximity to the grids and canteen/ toilets.

The sites are fairly generous in size 5.7 meters x 5.8 meters (for side opening trailers, and some rear loading trailers, depending on configuration).

Or 3.3 meters x 7.6 meters. (for rear opening trailers).

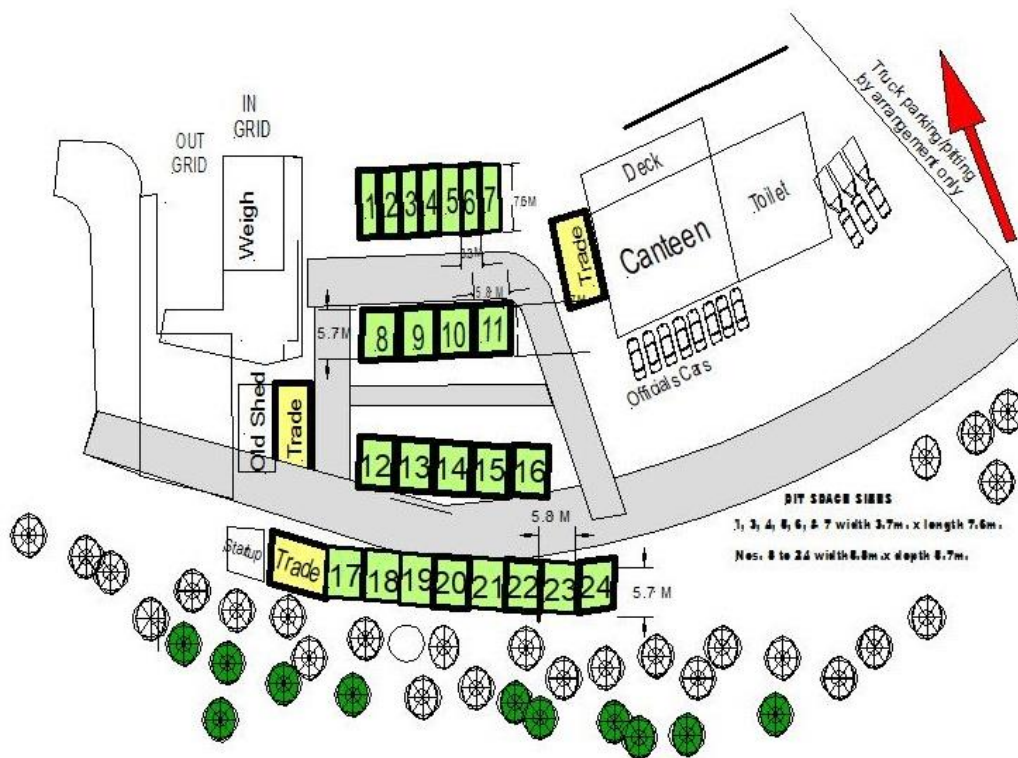

Sites numbered 1 to 7 and are \$40 each and are for rear loading trailers.

Sites 8, to 24, are also \$40 each and are for side opening trailers and some rear loaders

The advantages are.

- Guaranteed reserved spot no matter how late you arrive. Just rock up and take your spot. Easy access to your spot even when the pits are full.
- Convenient to canteen, toilets and grids.
- You can organize with a mate to get two or more together.

NOTE;

To take advantage of this offer your will need to enter through the CMS before pre entries close off prior to the event, and pay for the site up front.

Bank Details; South West Kart Club BSB 633-108 AC 145573861 Text or email bank receipt to Peter McDonald 042 9921774 | email auscar44@gmail.com

Note if payment is not confirmed within 24hrs. the spot will be reallocated.

PLEASE MAKE SURE YOUR TRAILER/ SHELTER WILL FIT IN THE ALLOTTED SPOT AS IT WON'T BE POSSIBLE TO ALLOW FOR ANY OVERHANG OF THE MARKED AREA.

Check our Facebook page for updates on which ones are taken as the meeting gets closer.

<https://www.facebook.com/South-West-Kart-Club-1465193293750915/>

We also have set aside a small number of longer spaces for team trucks along the south fence.

You will need to arrange with Peter to be able to utilise one of these.

If you don't want to take advantage of this offer or your setup requires more space. Remember we have plenty of pit space on a first come best dressed basis as usual.

Enquiries to; Peter McDonald 0429921774